

Driving Standards Authority Test Centre - Hull

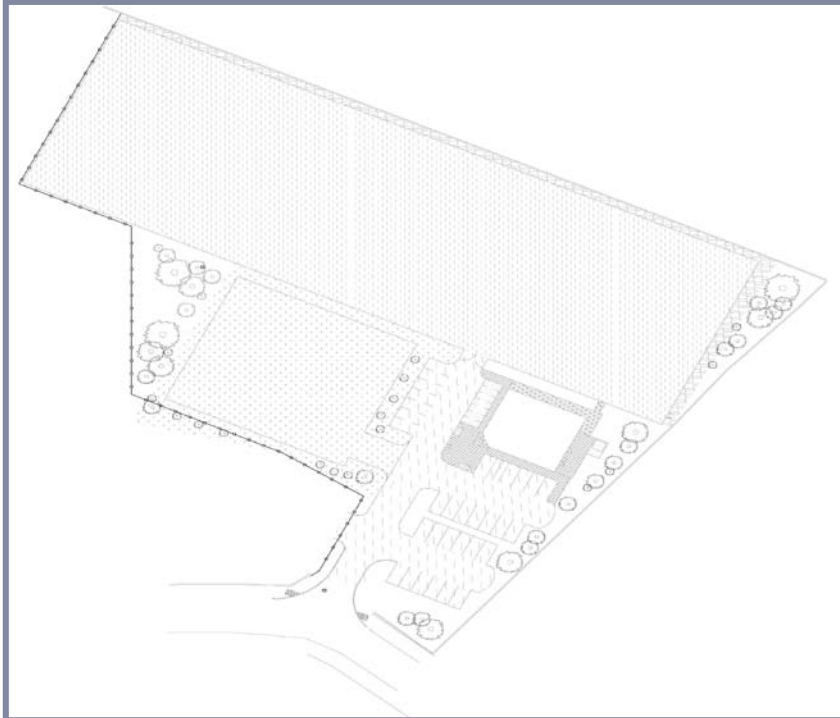

Project:

DSA Test Centre

Location:

Reservoir Road, Hull

Client:

Driving Standards Agency

Consulting Engineer:

Alan Wood & Partners

Architect:

PDD Architects

Contractor

S. Harrison Construction Ltd

Description:

The DSA test centre on Reservoir Road is constructed on 2 brownfield sites that were previously owned by Yorkshire Water authority.

Part of the site was heavily contaminated with Naphthalene, which had leaked from an adjacent paint factory and this had to be remediated by dilution prior to construction commencing on site.

The site is underlain by soft clays, which necessitated the use of vibropiling and raft foundation for the test centre building. A lightweight steel frame construction was used for the building superstructure.

A large motorcycle maneuvering area was also constructed to meet the DSA specification for a 125m x 40m yard area with a constant gradient, free of gullies and manholes etc. This was achieved using integrated kerb drainage to the maneuvering area.

The drainage system was designed to achieve an attenuated flow from the site to rates agreed with Yorkshire Water Authority. The storage capacity was provided using oversize pipes within the site.